

Software installation

- OptiMe
- OptiMe with Fresh Milk



Content

1. Prepare the software
2. Install the software
3. Load back-up data

1. Prepare the software

New software can easily be installed on the machine.
New software is available in the following ways:

- www.animo.eu / MyAnimo (dealer login)
- by e-mail from Animo Technical Support

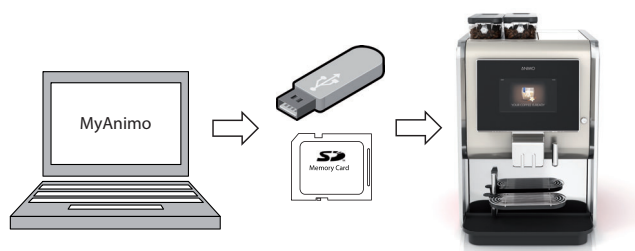

When loading new software, all the existing settings are automatically saved on the SD card or USB memory stick.

After the software update, you can decide if you want to work with the factory settings or if you want to use the * saved settings which you made a back-up before the software update.

* Important note software update V1.0 to V1.1:

Personal- and recipe settings may not be reloaded after the software update. The machine must be completely adjusted again.

If the machine is already equipped with version V1.1 or higher, the Personal- and recipe settings may be reloaded after the software update.

Screensaver movies-, picture-, counters-, log- and operating hours will be preserved!

The complete software update takes approximately 5-8 minutes.

Download the software.

Unpack the ZIP file and copy all directories and files (see right) into an empty SD card or USB stick.



File names (.apk and .ahx) may differ, depending on Software version.

SD:

- standard
- standard freshmilk
- 1.1.xxxx.ahx
- 1.1.xxxx.apk
- ani.ani

2. Installation new software

1. Leave the machine switched on and remove the stainless steel cover plate inside the door.
2. Opening [A] must be used for an SD card, Opening [B] must be used for a USB stick
Insert the prepared SD card [A] or USB stick [B] into the designated opening.

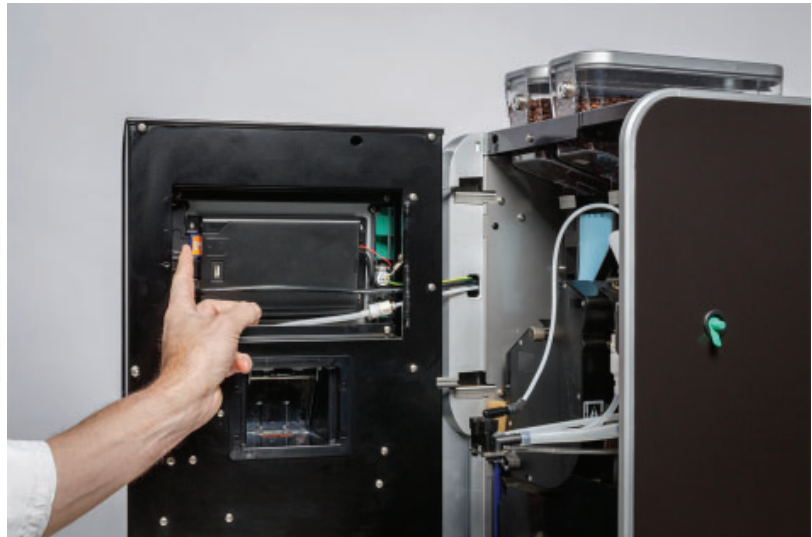
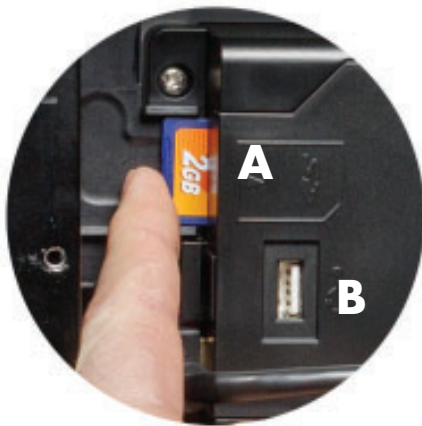

There are 2 ways to load new software in the machine.

- A Start with a switched ON machine
 - Follow the next pocedure 3.
- B Start with a switched OFF machine
 - Insert the SD card [B] or USB stick [C]
 - Switch ON the machine.
 - Follow point 5 to continue

3. Navigate to the automatic software update:

SERVICE MENU

2.11 SD/USB MENU

2.11.00 LOAD DATA/SOFTWARE UPDATE

2.11.00.06 AUTOMATIC SOFTWARE UPDATE

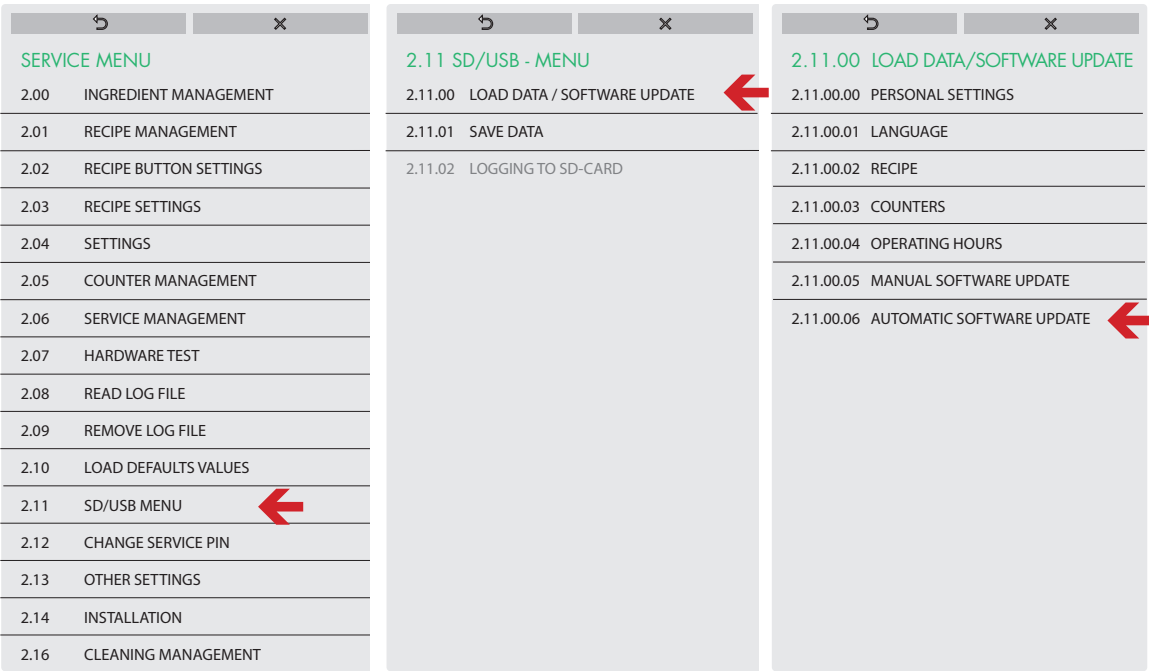

4. Press **OK** if you want to save the existing files from the machine (preferred).
Press **SKIP** if you do not want to save the existing files from the machine.



The personal files and recipe files are automatically stored on the SD/USB memory.

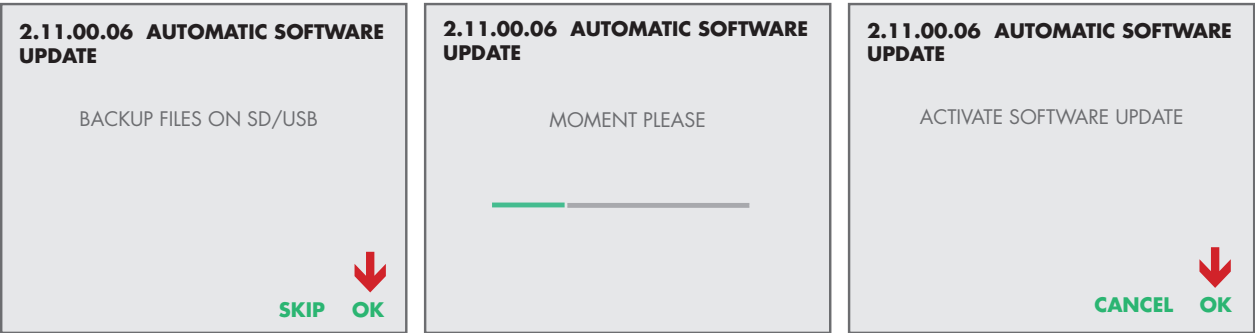

- Press **OK** to start the automatic software update.
Press **CANCEL** if you do not want to start the automatic software update, the machine will start up again.



The AHX file is being uploaded to the main PC board which is positioned behind the right-side panel.



File name (.ahx) may differ, depending on Software version.
If the machine does not detect files on the SD/USB memory, it will show NO DATA PRESENT ON MEDIA.

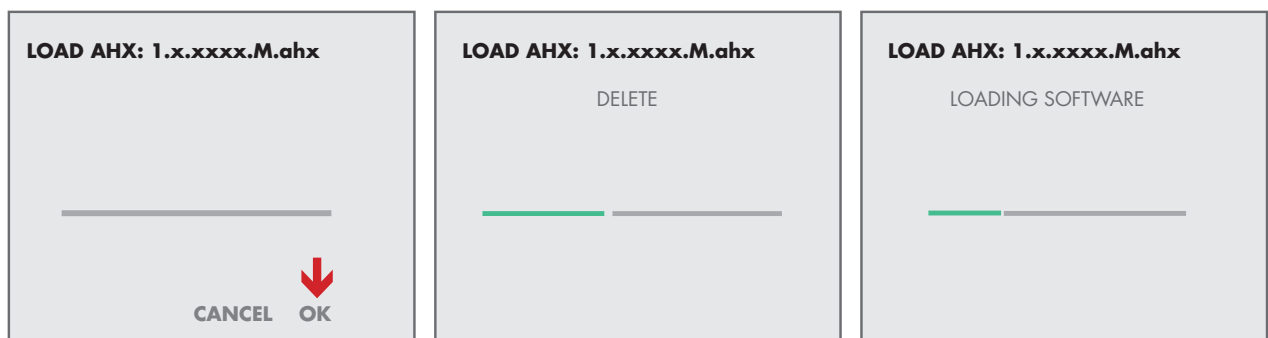

- Press **INSTALL** to continue the software update.

ATTENTION: Wait until below screen appears!
It can take some time before its visible on the screen



The application (.apk) is being updated to the PC board behind the display.

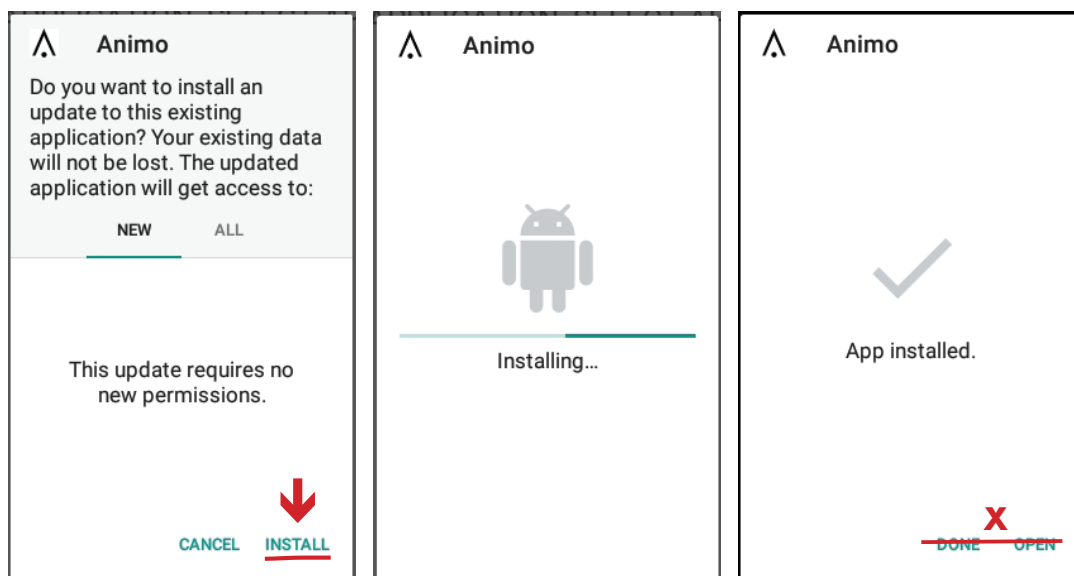

7. Select **Standard/** if the OptiMe is executed without fresh milk option or, select **Standard Fresh Milk /** if the OptiMe is executed with fresh milk option.

Press the **LOAD** button.



The machine model files, media files and recipe files are copied to the internal storage.

CHOOSE FOLDER

Android/

standard/

standard freshmilk/

PRESS LOAD TO START

../

Media/

Recipe/

LOAD

PRESS LOAD TO START

../

Media/

Recipe/

MOMENT PLEASE

COPY DATA TO INTERNAL STORAGE

8. Select the OptiMe model of your choice.
Use the table to (next page) to identify your model code



The selected model (3M xx) is being loaded, all the pre-programmed drinks are set on the display.

SELECT MODEL

3M 1× bb00

3M 2× bb00

3M 3× bb00

3M 4× bb00

3M 5× bb00

3M 6× bb00

3M 7× bb00

3M 9× bb00

3M A× bb00

3M C× bb00

SELECT MODEL

3M 1× bb00

3M 2× bb00

3M 3× bb00

3M 4× bb00

3M 5× bb00

3M 6× bb00

3M 7× bb00





3M 9× bb00

3M A× bb00

3M C× bb00

MOMENT PLEASE

MODEL IS BEING LOADED

OptiMe model code		Canister configuration		 Fresh Milk
	10	1x coffee / -	3M 1A	3M 1M
	11*	1x coffee / Topping	3M 2A	3M 2M
	11	1x coffee / Chocolate	3M 7A	3M 7M
	12*	1x coffee / Topping + Chocolat	3M 3A	3M 3M
	12	1x coffee / Topping + Sugar	3M 9A	-
	20	2x coffee / -	3M 4A	3M 4M
	21*	2x coffee / Topping	3M 5A	3M 5M
	21	2x coffee / Chocolate	3M AA	3M AM
	22*	2x coffee / Topping + Chocolat	3M 6A	3M 6M
	22	2x coffee / Chocolat + Sugar	3M CA	3MCM

XX* = default model

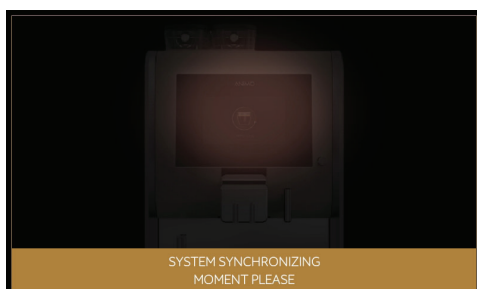

- The software update is successfully updated. The machine operates like a new machine that is straight from the factory. Remove the SD card / USB stick!



10. The machine needs to be restarted, so turn the machine OFF and ON again for 5 seconds.
11. If you want to load the saved settings (recipes) in the machine, leave the SD/USB memory in place and please follow the next chapter **3. LOAD BACK-UP DATA**.

* Important note software update V1.0 to V1.1:

Personal- and recipe settings may not be reloaded after the software update. The machine must be completely adjusted again.

If the machine is already equipped with version V1.1 or higher, the Personal- and recipe settings may be reloaded after the software update.

12. If your machine is equipped with an **XL-brewer (44 mm)** you must set the coffee dosage to a minimum of 10 grams and the number of brews on max. 50 puck's.

Login to Operator Menu -> Go to Service Menu 1.07

- Go to Menu 2.01 "Quick recipe pro" and set the amount of coffee for blend 1 or 2* per recipe to at least 10 grams.

- Go to Menu 2.13 "Settings", -> 2.13.00 "Waste Management", -> 2.13.00.00 "Number of brews" put this on max. 50 puck's.

* Only applies to OptiMe with two bean canisters

3. Load back-up data

1. Load the personal settings and the recipe settings, of which you made a back-up on the SD/USB memory before the software update was started, back into the machine.

Navigate to:

SERVICE MENU

2.11 SD/USB MENU

2.11.00 LOAD DATA/SOFTWARE UPDATE

2.11.00.00 PERSONAL SETTINGS

2.11.00.02 RECIPE

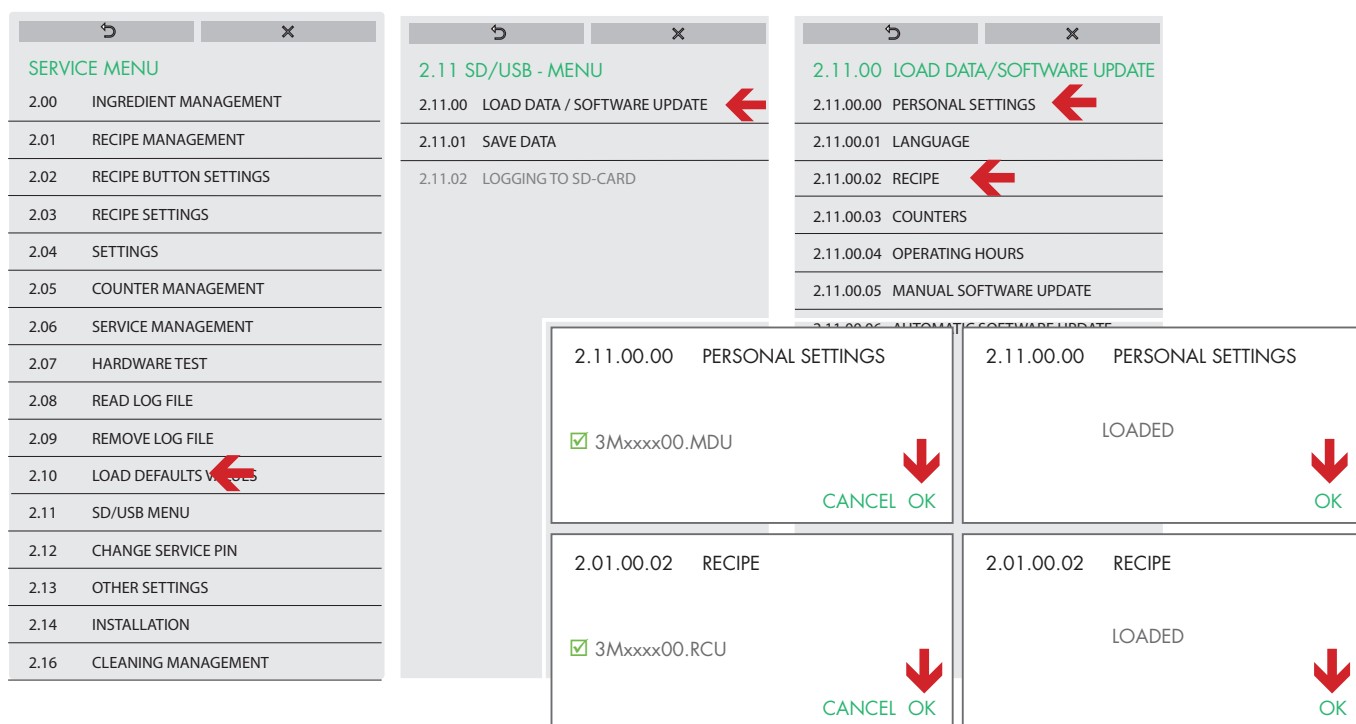

2. Remove the SD/USB from the slot.